

With several Genesis standard displays to choose from, selecting the size and configuration that meets your tradeshow needs is easy. Our modular exhibits are hassle-free because you pay no design fees, no shipping fees, and no repair or refurbishing fees. Plus, you may customize the panels and choose from a wide variety of accessories to create a unique exhibit that reinforces your brand and marketing efforts.

All packages include rental, delivery, installation, and dismantling. For other custom displays, hanging signs, or graphics, please call your Genesis Customer Service Representative at 502.266.5101.

**20x20 DISPLAY**

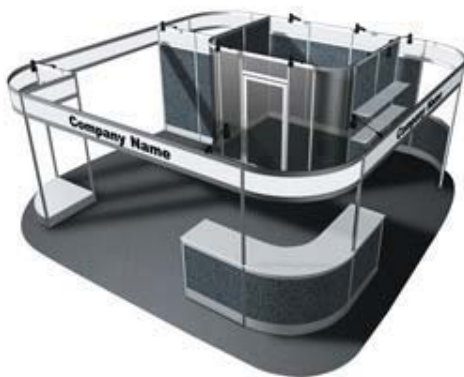

- 4012 - 20'x20' Island Display includes:
- three digitally printed header signs (117" x 12")
  - one locking office
  - four 1M x 12" deep shelves
  - one curved counter
  - two 1M counters
  - ten arm lights (order electrical separately)
  - one standard 20' x 20' carpet w/o padding

**10x20 DISPLAY**



- 4010 - 10'x20' Curved Display includes:
- one digitally printed header sign (117" x 12")
  - one 57-13/16" x 12" digitally printed header sign
  - one 2M counter
  - six arm lights (order electrical separately)
  - five 1M x 12" deep shelves
  - one standard 10' x 20' carpet w/o padding

**10x10 DISPLAYS**



- 4004 - 10' Backwall Display includes:
- one digitally printed header sign (117" x 12")
  - two arm lights (order electrical separately)
  - one standard 10' x 10' carpet w/o padding



- 4006 - 10' Deluxe Display includes:
- one digitally printed header sign (117" x 12")
  - three arm lights (order electrical separately)
  - five 1M x 12" deep shelves
  - one 1M counter
  - one standard 10' x 10' carpet w/o padding

**8FT TABLE DISPLAY**



- 4002 - 8' Tabletop Display includes:
- one digitally printed header sign (77 5/8" x 12")
  - three arm lights (order electrical separately)
  - two 1M x 12" deep shelves
  - one 8' skirted table
  - one standard 10' x 10' carpet w/o padding



4043 - 1M x 1/2M x 40" Cabinet w/locking doors



4044 - 2M x 1/2M x 40" Cabinet w/locking doors

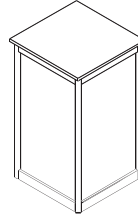

1/2M x 1/2M Pedestal (available in 30", 36" or 40" ht.)



4041 - 1M x 40" Curved Counter (open back)



4094 - Slatwall Panel upgrade 1M x 8'



4091 - Pegboard Panel upgrade 1M x 8'



4031 - 1M x 8' Freestanding Panel (graphics sold separately)



4021 - 1M x 8' Room Wall Panel  
4022 - 1M Locking Door Unit



4078 - Slatwall Hook  
Call for sizes and availability



4077 - Pegboard Hook  
Call for sizes and availability



4082 - Halogen Arm Light (150 Watt)



4071 - Display Shelf, White (1M x 12" deep)

**PANEL CHOICES**

STANDARD PANEL CHOICES:



Black PVC



White PVC

UPGRADED PANEL CHOICES:



Gray Fabric



Special Color PVC (call for available colors)



Special Color Slatwall / Pegboard



Full Panel Digital Graphics panels (call for pricing)

Remit to:



10801 Plantside Drive, Louisville, Kentucky 40299
Telephone: 502.266.5101 Fax: 502.266.5102
Email: orders@gen-expo.com

MATS #79-2024

Rental Displays & Accessories
Order Form

Discount Deadline Date: Wednesday, February 28, 2024

Artwork Deadline: Tuesday, March 14, 2023 to receive discount pricing.

Cancellation Policy: Cancellation after order processing will be at 25% of prevailing rate. Cancellation after delivery and/or installation will be at 100% of prevailing rate.

20' x 20' Displays

Table with 6 columns: Item #, Item Description, Qty, Discount, Standard, Total. Row 1: 4012, 20' x 20' Island Display, \$ 13,377.00, \$20,066.00

10' x 20' Displays

Table with 6 columns: Item #, Item Description, Qty, Discount, Standard, Total. Row 1: 4010, 10' x 20' Curved Display, \$ 9,009.00, \$13,514.00

10' x 10' Displays

Table with 6 columns: Item #, Item Description, Qty, Discount, Standard, Total. Rows: 4004 (10' Backwall Display), 4006 (10' Deluxe Display), 4002 (8' Table Top Display)

Indicate Carpet / Skirt Choice

Please select desired standard carpet color. Gray will be provided if no carpet color is indicated below:

- Black (04), Royal Blue (06), Blue Jay (92), Burgundy (11), Cayenne (93), Gray (09), Pepper (91), Red (14)

Please select desired skirt color (for 4002 - 8' Table Top Display). Black will be provided if no skirt color is indicated below:

- Lt. Beige (03), Black (04), Royal Blue (06), Navy (07), Burgundy (11), Yellow Gold (08), Expo Green (10), Plum (19), Seafoam (18), Red (14), Silver (15), White (16)

Electrical or Utilities Under Carpet?

- Yes, No

If yes, please submit a diagram indicating adjacent booth numbers to show orientation to insure proper placement before installing your exhibit. If a diagram is not submitted and services are installed in the improper location, Genesis will not be held responsible and labor fees will be applied to dismantle/move the structure.

Indicate Standard PVC Panel Color Choice

Please select desired standard panel color for your requested display, cabinet(s), counter(s) and/or pedestal(s). White PVC will be provided if no panel type/color is indicated below:

- Black PVC, White PVC

Payment Policy: Advance Discount: To obtain the discount pricing, your order with full payment must be received by the deadline date published above. Any orders received before the deadline date without payment will be charged at the standard rates.

- Yes, I have reviewed the Payment Policy and enclosed the Payment Form. All orders are subject to the terms and conditions as outlined on the payment form.

Booth Number: \_\_\_\_\_

Company Name, Street Address, City / State / Zip, Email, Phone, Fax, Print Name, Signature, Date

Accessories

Table with 6 columns: Item #, Item Description, Qty, Discount, Standard, Total. Rows: 4031 (1M x 8' Freestanding Panel), 4021 (1M x 8' Room Wall Panel), 4022 (1M Locking Door Unit), 4082 (Halogen Arm Light - Black), 4071 (Display Shelf, 1M x 12" deep), 4041 (1M x 40" Curved Counter), 4043 (1M x 1/2M x 40" Cabinet), 4044 (2M x 1/2M x 40" Cabinet), 4062 (1/2M x 1/2M x 30" Pedestal), 4063 (1/2M x 1/2M x 36" Pedestal), 4064 (1/2M x 1/2M x 40" Pedestal)

Display Panel / Accessory Upgrades

Table with 6 columns: Item #, Item Description, Qty, Discount, Standard, Total. Rows: 4093 (Spec. Color PVC Display Panel), 4097 (Spec. Color Cabinet/Counter/Ped.), 4090 (Gray Fabric Display Panel), 4094 (Slatwall Display Panel - White), 4091 (Pegboard Display Panel - White), 4095 (Spec. Color Slatwall Panel), 4092 (Spec. Color Pegboard Panel)

Prices are in addition to the price of the requested standard display/accessory and are figured per display panel and/or cabinet/counter/pedestal. Call for available colors.

Digital or Standard Vinyl ID Sign Copy

Digital ID Signage is included with each display rental. Please email your artwork to graphics@genexpo.com. If a Digital ID is not required, your company name in standard black vinyl lettering on a white background will be provided.

Full Panel Graphics

Full Panel Digital Graphics are available at an additional cost. Please submit your artwork to graphics@genexpo.com for pricing. An EPS Vector format file, with all fonts converted to outline, is required as well as a hard copy with the order to receive custom graphics. No refunds on artwork cancelled after production.

Subtotal This Form: \$ \_\_\_\_\_

Copy this subtotal to the Payment Authorization Form where 6% SALES TAX will be calculated.